

# Indigo Shibori

## -the works of Motohiko Katano

April 2nd to June 16th, 2019

Motohiko Katano (1899-1975), known as a leading specialist of shibori (tie-dye) with natural indigo, established an original technique of his own, which is later called 'katano shibori'. Splendid works by Katano such as kimonos, tapestries, noren curtains are introduced in this exhibition. Works by Kaori, daughter of Motohiko who had sincerely supported her father throughout her life, are also exhibited.

Exhibition cooperation: Studio Sōdo-sha, Takeda-Kahei Co.

### Indigo Shibori

-the works of Motohiko Katano

#### NOTICE:

Please do not touch the exhibited works.

The use of pens, fountain pens, or watercolors are prohibited.

Photography is not allowed in the gallery.

Please switch off your cell phones.

#### THE JAPAN FOLK CRAFTS MUSEUM

[www.mingeikan.or.jp/english/](http://www.mingeikan.or.jp/english/)

tel 03-3467-4527 / 4-3-33, Komaba, Meguro-ku TOKYO

#### FIRST FLOOR

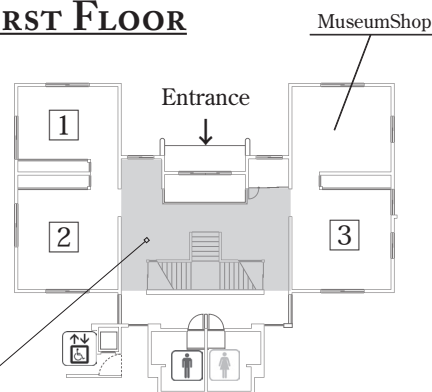

1F Entrance

#### SECOND FLOOR

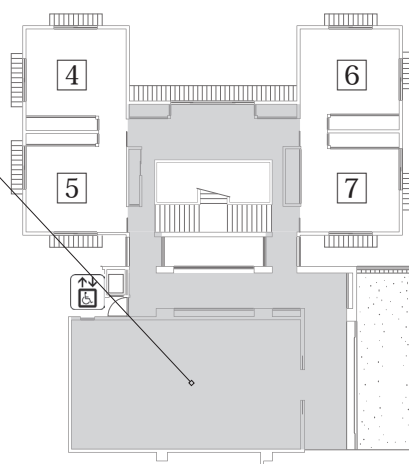

2F Main Hall

## Thematic Exhibition

### 1 Crafts of Leather, Bones and Horns

Crafts of deerskin and cowhide had come into wide use during late Edo period such as stylish coats for craftsmen, fire coats for fire fighters, or tobacco pouches as men's waist accessories. This room shows leather crafts, and craft works of animal horns, tusks and bones.

### 2 Ceramics in Japan

The museum collection of ceramics exceeds 3800 in number and includes both new and old. The standard of our collection is its beauty, not its period, place nor purpose of use. This room displays about 50 ceramic works from various regions in Japan, kilns in Kyushu and Tohoku, Seto (Aichi Prefecture), Tamba (Hyogo Prefecture) and Tsuboya (Okinawa Prefecture).

### 3 Fabrics of Bast Fiber

Natural fiber classify into animal-origin and plant-origin. Fiber made from tree barks and phloem is called bast fiber. Bast fiber had been widely used in common people before cotton has become popular. This room introduces fabrics by the blessing of nature such as ramie, wisteria, linden, kudzu and papers.

### 7 Figure Paintings and Portraits

This room displays figure paintings and portraits from middle ages to early modern times. For example, the portrait of Kou-matsu-maru Mouri who had inherited his family name at the age of 2 and passed away of disease at 9 during the warring state period, Otsu-e figure paintings of a beautiful woman similar to hand-drawn Ukiyo-e.

### 4 Pictures and Ceramic Paintings by Bernard Leach

The works by a potter Bernard Leach (1887-1979) include not only drawings and etchings but also handicrafts with pictorial expression of ceramic paintings in various techniques. Exhibits focusing Leach's "paintings" with distinctive soft lines.

### 5 Crafts of Joseon Period

From 15th century to 19th century, utensils made and nurtured by ordinary people in Korean Peninsula have been handed down as the quintessence of crafts today. Soetsu Yanagi, founder of the museum, recognized their beauty in his early stage, collected them, and exhibited them publicly. In this room shows folk crafts of Joseon period such as ceramics, woodworks, paintings, mason works, and metal works.

### 6 Toys as Crafts

Soetsu Yanagi had admitted its excellence in recreational crafts such as cards which familiarized in people of early modern times, and dolls which are rich in regional colors. This room introduces toys from our collection such as cards, dolls, tops, and battledores.