

# CELEBRATING THE 100TH BIRTHDAY SAMIRO YUNOKI EXHIBITION

JANUARY 13TH TO APRIL 2ND, 2023

The characteristics of dyer Samiro Yunoki's works are pure patterns and clear colors. This exhibition, celebrating his 100th birthday, introduces his early to recent works as well as crafts from various ages, different production areas and techniques. Well-harmonized with these works, Yunoki's textiles will be full of lively joy, and bring you emotion and charms.

## NOTICE

- Please do not touch exhibited works and showcases.
- The use of tools which can damage artworks such as pens or ink brushes are prohibited.
- Please refrain from using cell phones.
- Please do not take photographs or movies except designated areas.

## Notice for Photographic Area:

Side wall glass case in the Main Hall (2nd floor) is the ONLY area for photographs.

### PLEASE

- No flash, no tripods.
- Please respect other visitors while taking photographs.
- Please do not process.
- Please be careful of the portrait rights of other visitors in your photos.
- For non-profit and personal use only.

## THE JAPAN FOLK CRAFTS MUSEUM

[www.mingeikan.or.jp/english/](http://www.mingeikan.or.jp/english/)

tel 03-3467-4527 / 4-3-33, Komaba, Meguro-ku TOKYO

## FIRST FLOOR

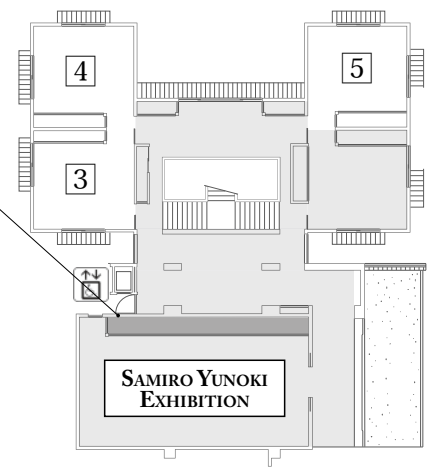
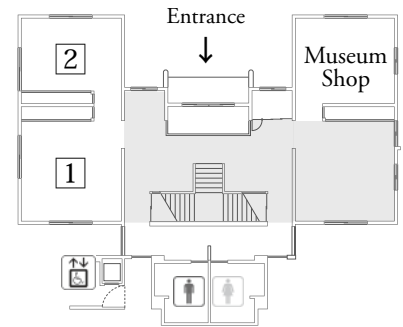

## SECOND FLOOR

## THEMATIC EXHIBITION

### 1 CERAMICS IN KYUSHU AND OKINAWA

Ceramics in Kyushu received the influence from Korean ceramics, and had developed dramatically at various kilns since the 16th century. In Okinawa, techniques introduced from Satsuma (present Kagoshima prefecture) and Okinawan environment married, and original ceramics were born mainly in Tsuboya. This room exhibits ceramics of both Kyushu and Okinawa.

### 2 LEATHER CRAFTS (exhibition period: 2/1 to 4/2)

Leather half-coats with a designed family crest or family name on back and/or collar had been worn as attire for fire fighters or master craftspeople. They were stenciled with patterns and smoked to color by pine needles or straws. This room displays leather half-coats and other leather crafts such as smoking implements from our collection.

### 3 TEA BOWLS FROM THE KOREAN PENINSULA

In our 600 ceramic collection from the Korean peninsula, around 70 tea bowls are included. Ido tea bowls which have been exceptionally valued since the time of early tea masters, bowls with brush marks, buncheong, Komogai; all vary and please our eyes.

### 4 MINGEI MOVEMENT AND MASHIKO

Shoji Hamada founded pottery with Bernard Leach in England. After his return to Japan, Mashiko in Tochigi prefecture became his foothold which was a half-farming half-mass-producing-potteries area. This room exhibits traditional Mashiko works, works by potters who moved to Mashiko influenced by Hamada, and Leach's works in Mashiko.

### 5 CELEBRATING SPRING – MAINLY TOYS AND DOLLS

Japanese traditional playing games such as *karuta* cards, wooden rackets called *hagoita* and girl's festival dolls are generally related to events on seasonal changes. They are abundant in regional characteristics, therefore Soetsu Yanagi admitted them as excellent crafts. Introduced are crafts for celebrating New Year and Doll's Festival in March with several New Year decorations.