

Commemorating the 130th anniversary of his birth

THE WORLD OF KEISUKE SERIZAWA

SEPTEMBER 5TH (THU) TO NOVEMBER 20TH (WED)

Dyer Keisuke Serizawa (1895-1984) was a genius of a unique sense of color and patterns. Supported by his everyday sketches of his surroundings or what he saw in his daily life, his various works fascinate people's minds. Also, this exhibition involves Serizawa's collection, which Yanagi described 'We could share solid values and understand each other through his collection.' On the coming occasion of the 130th anniversary of his birth, please enjoy the world of Serizawa's hand and eyes.

FEATURE EXHIBITION THE EYES OF SERIZAWA

Yanagi appraised Serizawa's eyes with the comment 'he could see the genuine beauty'. Serizawa had collected crafts from various fields worldwide with an open mind. In this room, we focus on the collected works that Serizawa himself referred to as "another creation" alongside the Shizuoka City Serizawa Keisuke Art Museum collection to present his unique perspective.

NOTICE

- Please do not touch exhibited works and showcases.
- The use of tools which can damage artworks such as pens or ink brushes are prohibited.
- Please refrain from using cell phones.
- Please do not take photographs or movies except designated areas.

Notice for Photographic Area:

Side wall glass case in the Main Hall (2nd floor) is the ONLY area for photographs.

PLEASE

- No flash, no tripods, no video recordings.
- Please respect other visitors while taking photographs.
- Please do not process.
- Please be careful of the portrait rights of other visitors in your photos.
- For non-profit and personal use only.

FIRST FLOOR

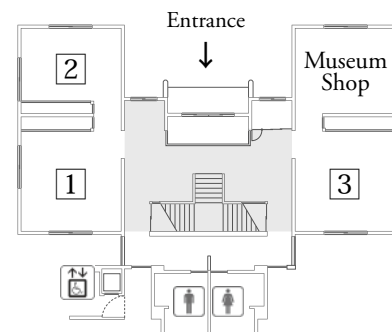

SECOND FLOOR

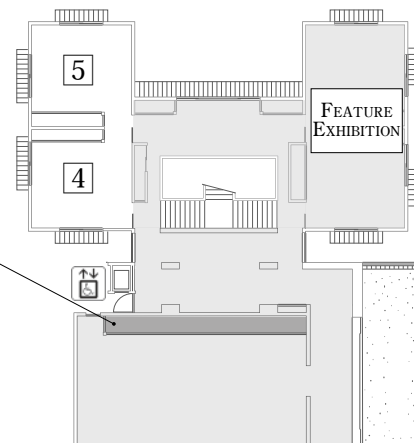

THEMATIC EXHIBITION

1 NATURAL ASH GLAZE AND KILN TRANSFORMATION

Kiln transformation refers to unexpected changes that occur on the surface of pottery due to the interaction between ash from wood fuel and the flames. Many of the early modern Tamba ware pieces in our collection exhibit vibrant colors resulting from this kiln transformation. Alongside pottery with natural ash glazes formed by ash falling onto unglazed surfaces, we introduce these old ceramics that reveal kiln transformation.

2 EUROPEAN AND AMERICAN WOODCRAFTS

The wood crafts collection of our museum is curated without restrictions of country nor era, focusing instead on pieces that possess wholesome aesthetic beauty. To mark the second anniversary of the Murata Collection's donation, we will exhibit exquisite works including chairs from the Collection alongside wood crafts created in Europe and America.

3 PERFORMING ARTS COSTUMES

In traditional Japanese performing arts, Noh, which was established during the Muromachi period (1336-1392), is well known. In addition, various musical and dance performances have been passed down through festivals and seasonal events held in ordinary life. This room will focus on Noh costumes used in performances and costumes worn in various local performing arts.

4 DESIGNS OF JOSEON CRAFTS -MAINLY WITH ANIMAL DESIGNS

Crafts and paintings from the Joseon Dynasty depict a wide variety of animals from those familiar to us today to mythical creatures revered as spiritual beings. These lively depictions ranging from delicate and poetic expressions to bold and humorous ones, continue to captivate us.

5 CRAFTS FROM TOHOKU REGION

Soetsu Yanagi noted that the Tohoku region (Northern region of Japan), due to its harsh climate and lack of easy access to transportation, had preserved many of its traditions and unique local crafts. This exhibition will display and introduce a wide range of traditional items created and used in Tohoku, spanning various fields such as ceramics, lacquerware and metalwork.

THE JAPAN FOLK CRAFTS MUSEUM

www.mingeikan.or.jp/english/

tel 03-3467-4527 / 4-3-33, Komaba, Meguro-ku TOKYO